

True Roof™ Vented Panel

ZIP system™ Roof Sheathing

Rafters, Oriented to Create an Air Vent between Sheathing and Insulation from Soffit to Ridge

Double Foil-Faced Extruded Polyisocyanurate Insulation, 6" (with options to 10") Thickness Vertically Oriented

Foil-faced Polyisocyanurate Insulation, 1" Thickness Horizontally Oriented to Form an Effective Air Stop

1/2" Drywall Thermal Barrier

Vapor Barrier

Pre-applied 1x8 Pine V-Groove Interior Finish (Optional)

True Wall™ Panel

R-Wrap House Wrap

Pre-installed Windows

Double Foil-Faced Extruded Polyisocyanurate Insulation, 4" (with optional 6") Thickness

2x6 (with optional 2x8) Wall Studs 16" On Center

5/8" CDX Douglas Fir Plywood Sheathing

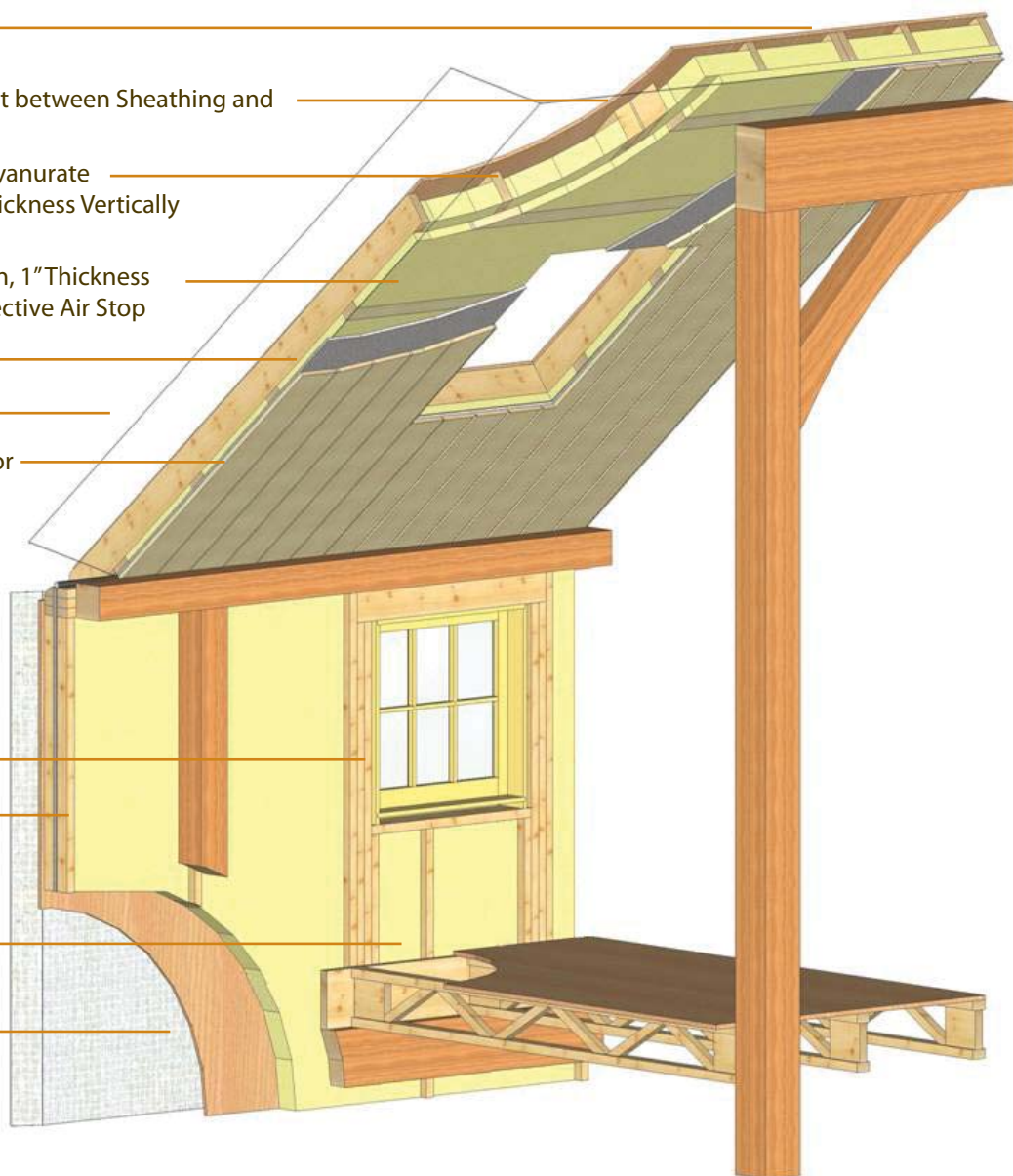

YANKEE BARN HOMES True Roof™ and True Wall™ Panels were designed to combine the highest performing attributes of traditional stick-built construction with Structural Insulated Panels (SIPs). Like a SIP, True Roof and Wall Panels layer an exterior wood sheathing over a rigid foam core insulation. True Roof and Wall Panels, however, incorporate structural studs for enhanced strength and durability.

TRUE WALL™ PANELS are built with the windows pre-installed. This eliminates the waste created by the time-consuming process of cutting into SIP panels on-site to install windows. Furthermore, the wood sheathing of a SIP is affixed to the rigid foam insulation with glue, whereas a True Wall Panel is sturdily fastened to 2x6 studs. Contractors remark that True Wall Panels are easy and fast to install.

TRUE ROOF™ PANELS create a vented "cold roof" system, preventing snowmelt from forming dangerous icicles in the winter and providing a buffer from the heat of the sun's summer rays. True Roof Panels are the only roof panels of their kind that bear the International Code Council (ICC) approval.

